

Y - STRAINER

STRAINER cast iron, flanged, Y-type			
PN6 - 0,6 MPa	DN 15 - 200	Maximum working temperature 300° C	Fig. 821
PN16 - 1,6 MPa	DN 15 - 400		
PN25 - 2,5 MPa	DN 15 - 200		

APPLICATION

Industrial cold and hot water
(also for drinking water), steam, neutral fluids.

ADVANTAGES

- screen made of stainless steel,
- strong construction of screen,
- cleaning of screen without disassembling,
- asbestos free,
- environment-friendly.

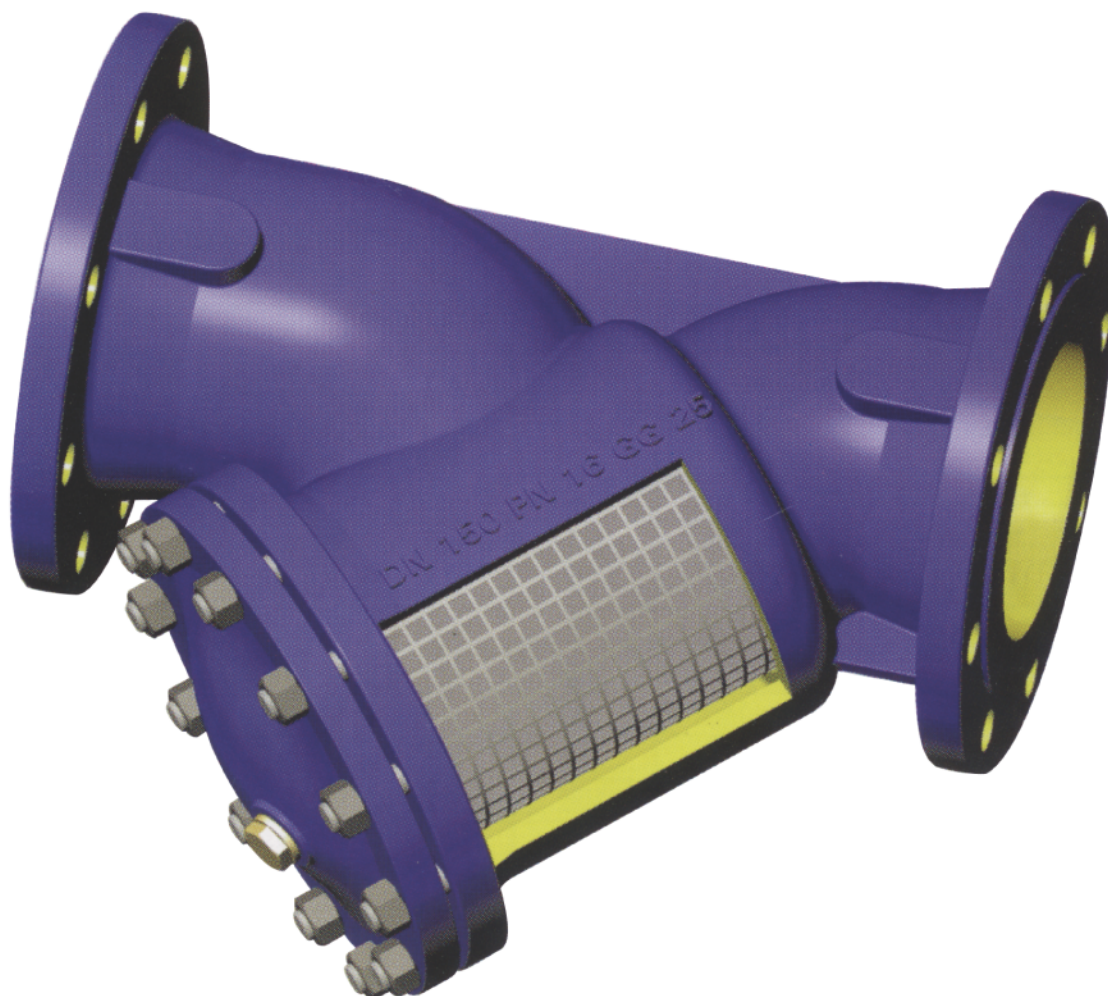

Note:
Material in accordance to the Polish Standard,
in the brackets-according to the DIN.